







# Jackson Hall



Updated: 18-02-2021

# Legends

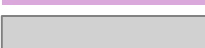
## Shading Colour Legend:

Lab space:	
Lab Support Area	
Office space:	
Central classrooms:	
Departmental classrooms/seminar rooms:	
Departmental study space:	
Construction zone:	

## Border Highlights Legend

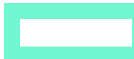
Mechanical Engineering	
Computing	
Electrical Engineering	
Applied Science Offices	

\*Unlabeled rooms are non-assignable

\*For use of corridors, common areas, and washrooms, refer to guidelines

\*Unless specified, occupancies are calculated using the 1 person per 18.5 m<sup>2</sup> guideline

\*Research Lab occupancies have been increased to 1 person per 14 m<sup>2</sup> to a maximum of 4 additional people.

\*When furniture layout is known, occupancies have been calculated using 2m separation metric

# Basement

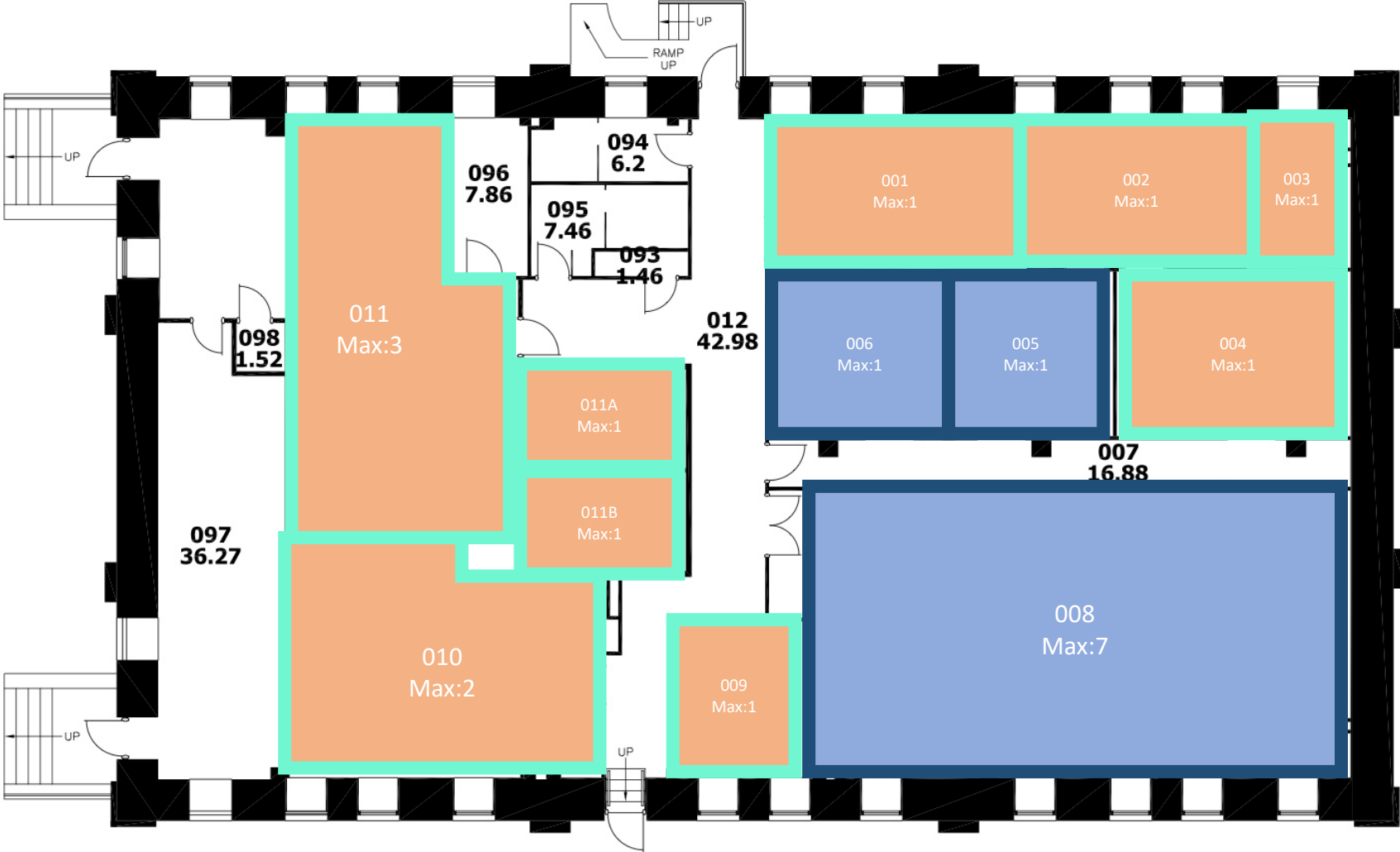

BASEMENT

# 1<sup>st</sup> floor

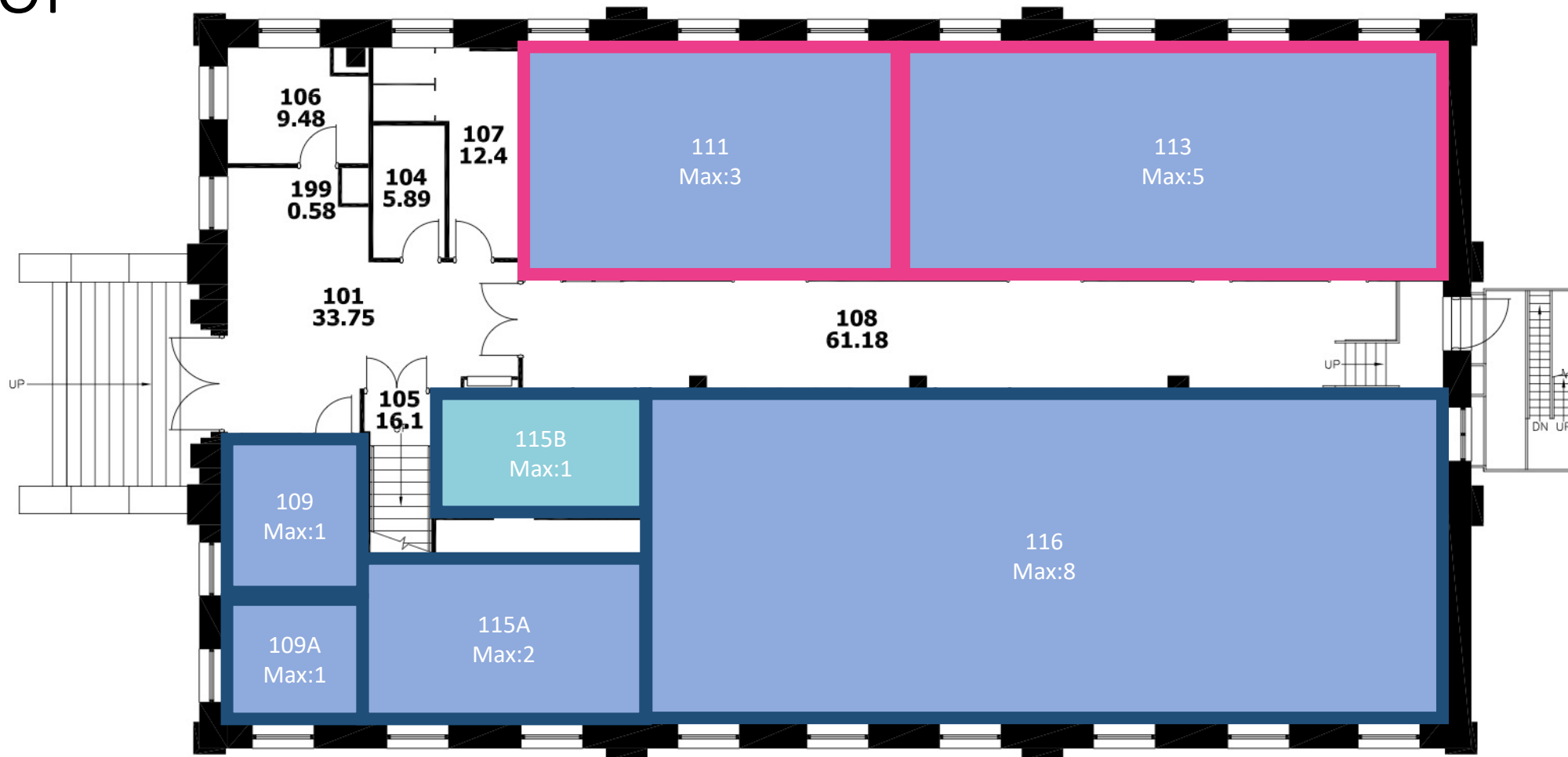

FIRST FLOOR

# 2<sup>nd</sup> floor

Construction Period: June - July 2020



SECOND FLOOR

# 3<sup>rd</sup> floor



THIRD FLOOR