







# Robert Sutherland Hall

Updated: 22-06-2020

# Robert Sutherland Hall

## Shading Colour Legend:

Lab space:	
Office Space:	
Departmental classrooms/seminar rooms:	
Departmental study space:	
Exhibition/assembly space:	
Non-institutional agency:	

## Border Colour Legend:

Arts and Science Office	
Computing	
Economics	
Geography	
Industrial Relations	
Internal Audit	
Law	
MIR Program	
Other, Agencies, etc.	
Policy Studies	
Registrar	
University Secretariat	

\*Unlabeled rooms are non-assignable

\*For use of corridors, common areas, and washrooms, refer to guidelines

\*Unless specified, occupancies are calculated using the 1 person per 18.5 m<sup>2</sup> guideline

\*When furniture layout is known, occupancies have been calculated using 2m separation metric

# Level 1

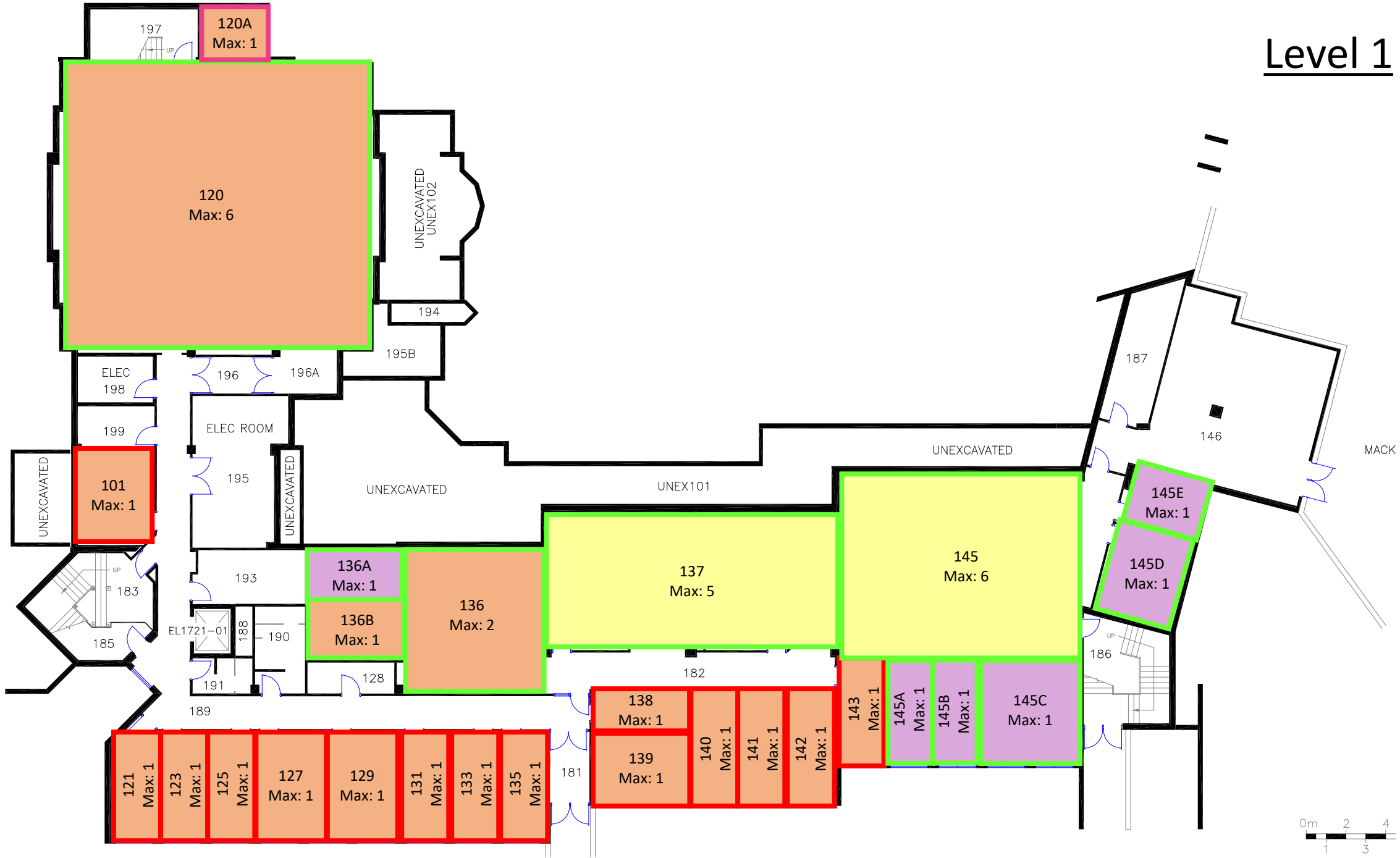

# Level 2

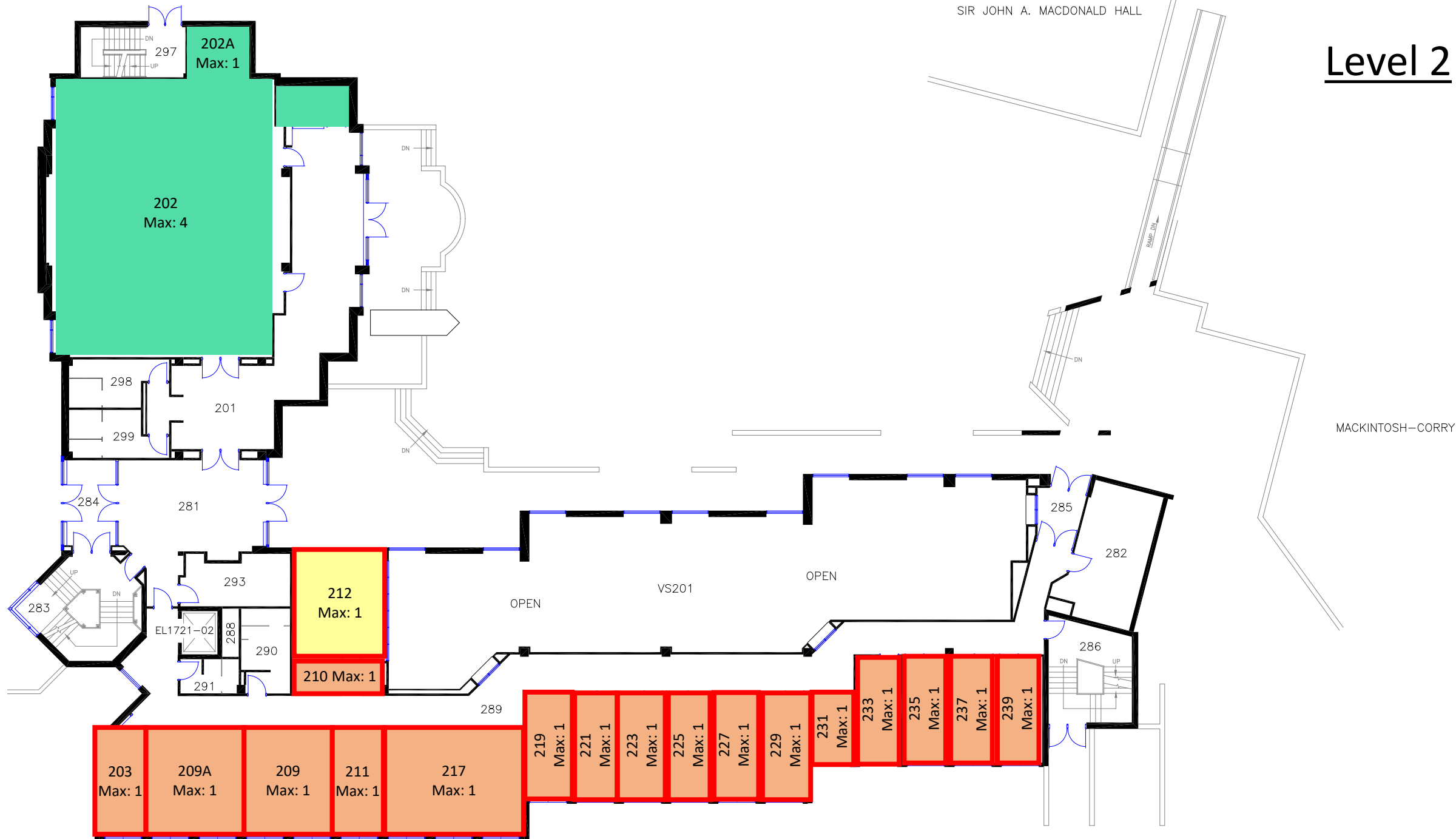

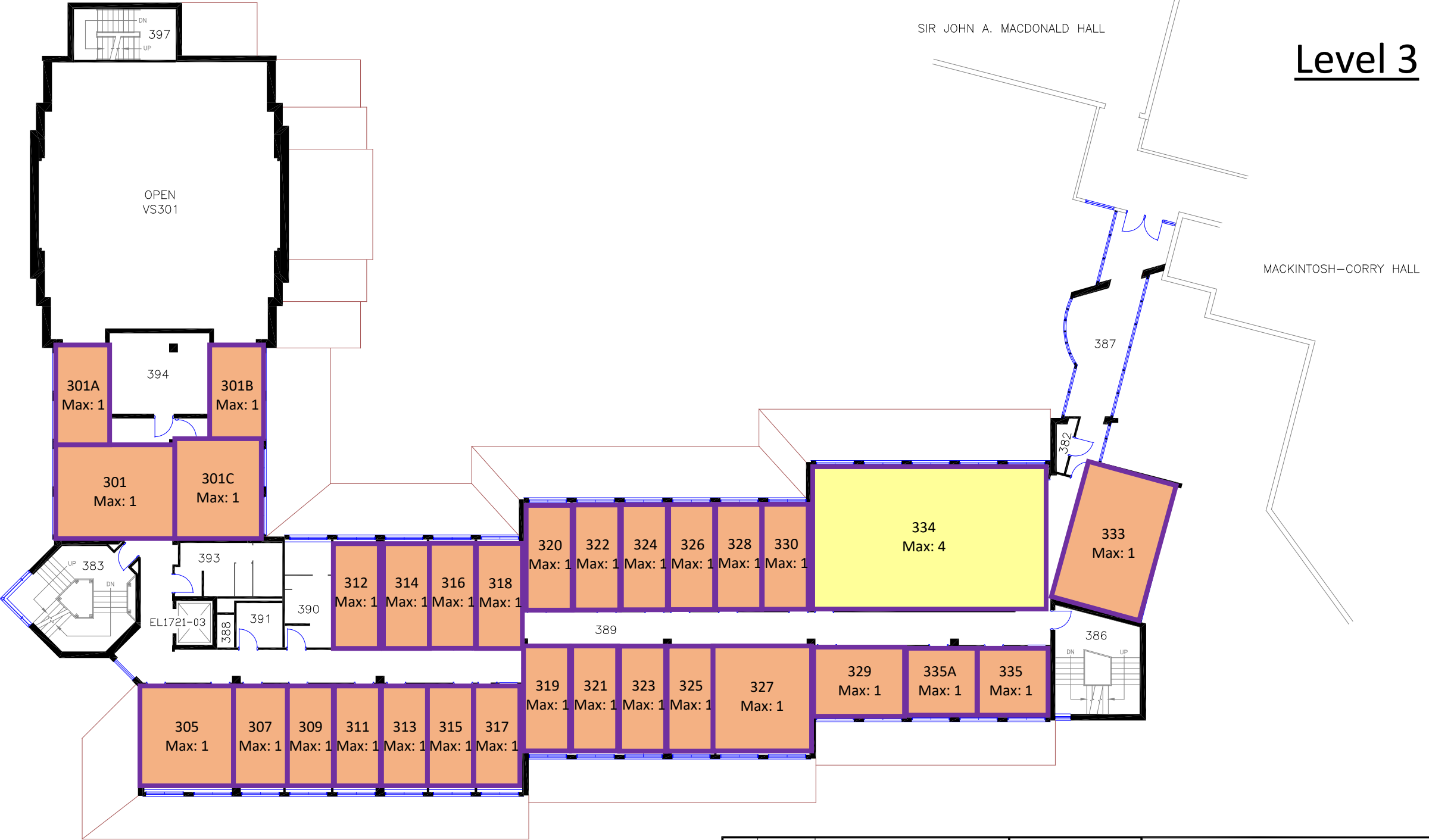

# Level 4

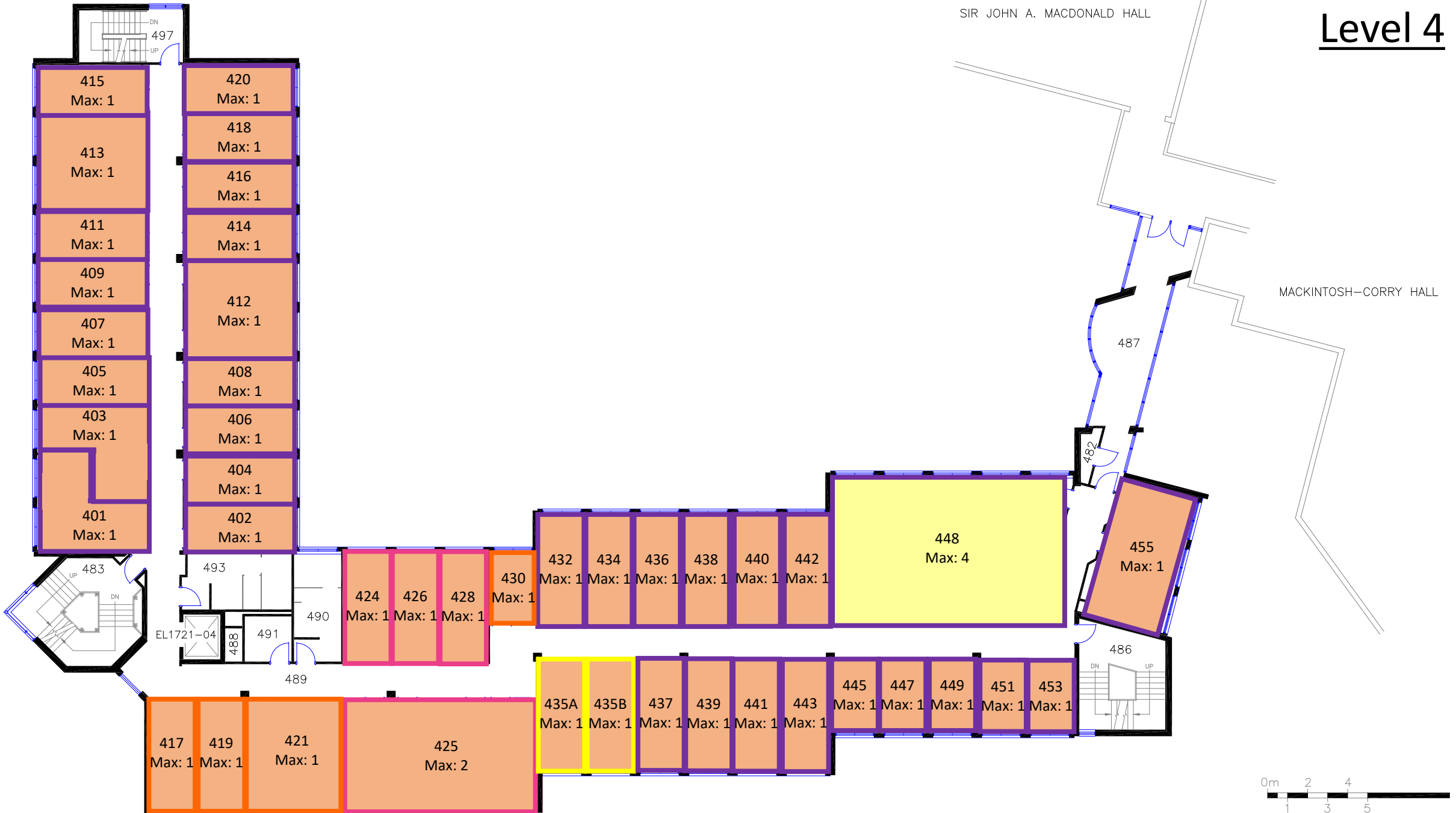

# Level 5

